

**Kent County Health Department**  
**Water Supply/ Waste-Water Disposal Facility Permit**  
 Environmental Health Division 616-632-6900 FAX 616-632-6892  
 700 Fuller Avenue NE, Grand Rapids, MI 49503

Location/Address: 4150 Grand River Dr. NE  
 City, Village, or Twp.: Plainfield Township Subdivision & Lot No.: \_\_\_\_\_  
 Owner: Klaas Kwant Phone No: 616-706-5812  
 Address: 1362 Butth Dr. NE City: Comstock Park State: MI Zip Code: 49321  
 Perm. Parcel No.: 41-11-31-100-016 E-mail address: kkwant@gccc.edu

This permit authorizes the construction, repair, enlargement, or relocation of a well/sewage disposal facility in accordance with plans and information contained in the approved application submitted to the Kent County Health Department on 5/12/06. Work authorized by this permit shall be subject to any special conditions or requirements as noted on the permit and shall comply with all requirements of the Water Supply Regulations and/or Sewage Disposal Regulations of Kent County. It shall be unlawful for any well/sewage disposal facility constructed, repaired, enlarged, or relocated under authority of this permit to be placed in operation without prior approval by the Kent County Health Department. This permit is valid for two years from the date of issuance and is not transferable to any person or location. No work shall be commenced or continued either before the permit is issued or after the permit has expired.

**Building Information:**  New  Repair  House  Mobile Home  Duplex  
 No. Of Bedrooms: 2  Commercial \_\_\_\_\_ gal/day flow

**Water Supply Well Details**

Well Type:  Domestic  Commercial  Irrigation  
 Recharge  Test Well  De-watering

**PRE-SITE INFORMATION**  
 201 Contamination Sites \_\_\_\_\_  
 L.U.S.T. Storage Sites \_\_\_\_\_  
 S.F.E. Evaluation Information \_\_\_\_\_  
 Plat Restrictions \_\_\_\_\_

**ISOLATION REQUIREMENTS:**  
 \_\_\_ Feet from on-site sewage disposal system(s)  
 \_\_\_ Feet from municipal sewer lines  
 \_\_\_ Feet from overhang of building  
 \_\_\_ Feet from sewage sump  
 \_\_\_ Feet from fuel storage tank(s)  
 \_\_\_ Feet other (specify) \_\_\_\_\_

**INSPECTIONS REQUIRED:**  
 Pre-Construction  Construction  
 Grouting  Other \_\_\_\_\_  
 Final Inspection

**RESTRICTIONS:**  
 Minimum depth in feet \_\_\_\_\_  
 Feet pump submergence required \_\_\_\_\_  
 Grouting \_\_\_\_\_  
 Well abandonment  
 10' Continuous protective clay barrier at greater than 25'

**Waste-Water Facility Details**

**Isolation Requirements:**  
50 Ft. from water well(s). 10 Ft. from basement wall(s)  
50 Ft. from surface water(s), 10 Ft. from lot lines or R.O.W.  
25 Ft. Other Footing drains

**Aggregate and Cover Requirements**  
12 In. soil cover over aggregate 2 In. aggregate above pipe  
4 In. Dia. Pipe 6 In. aggregate below pipe

**Soil Texture:** Med. sand to 4', sandy clay loam 4' +

**Septic Tank Requirement:** No. of Tanks: 2  
 Capacity 800 gal., 800 gal.  
 Pump Chamber n/a gal.

<input type="checkbox"/> <b>Drain field:</b> Base Area _____ Sq.Ft. Side Area _____ Sq.Ft. <b>Total</b> _____ Sq. Ft. Trench Width _____ Ft. Total Linear Ft. _____ Of Trench <u>38849</u> Ft.	<input checked="" type="checkbox"/> <b>Drain Bed:</b> Base Area <u>675</u> Sq. Ft. Side Area <u>0</u> Sq. Ft. <b>Total</b> <u>675</u> Sq. Ft. <u>15</u> Ft. X <u>45</u> Ft. No. of Laterals <u>3</u>
--	---

**Other:**  
 Specify: \_\_\_\_\_  
 \_\_\_\_\_  
 Strip topsoil and place 6" of washed 2NS in drain bed area.  
 See notes and cross section on page 2.  
 \_\_\_\_\_  
 \_\_\_\_\_

*Final Inspection is Required. Please contact this office when well is completed to arrange for inspection and water sampling.*

*Final Inspection Required. Please contact this office before 9:00 a.m. for final inspection prior to backfilling.*

See Attached Sketch For Location Details and Additional Information.

Signature of Sanitarian: Jason Buck **Jason Buck**

Date Issued: 6/6/06

Address: 4150 Grand River Dr. NE

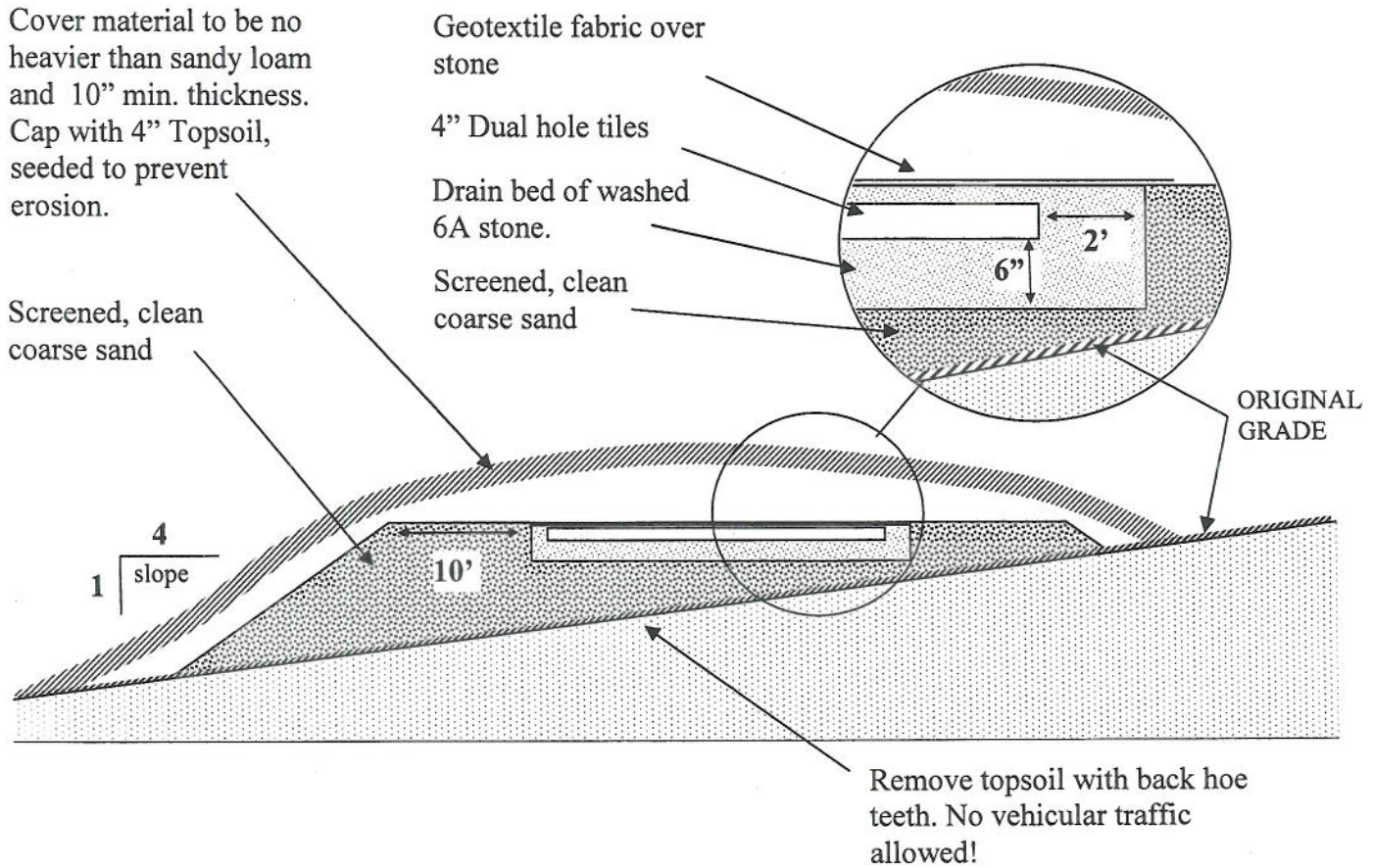

## COMMENTS:

### **ADDITIONAL FLOODPLAIN AND SOIL EROSION PERMITS MAY BE NECESSARY!**

Keep the house elevation as high as possible to achieve gravity flow to the septic system. A sewage lift pump may be needed for basement plumbing. It is recommended that an effluent filter and service riser be installed on the second septic tank. Divert all footing drain and water softener discharge away from the septic system.

Place septic system in location shown on page 3. Remove topsoil and vegetation in the drain bed area and roughen with the back hoe teeth prior to placing fill. Do not use a dozer or drive equipment over the mound area! Place a bed of screened, clean, coarse sand in the drain bed area as shown in the above cross section and on page 3. The sand fill must be a minimum of 6" above the highest point of the septic system area. The sand fill must be level extending 10' from all sides of the drain bed (see diagram above). The sides of the fill must be a 4:1 slope.

Place a bed of washed 6A stone centered over the sand fill. The stone should be carefully placed with a back hoe to avoid compaction of the fill. Lay the laterals and manifold in the stone in the configuration shown on page 3. Cover the laterals with 2" of washed 6A stone. Prior to backfilling, the stone must be covered with geotextile fabric.

Please call 616-632-6906 with questions and for final inspections.

Project: 4150 GRAND RIVER DR. NE

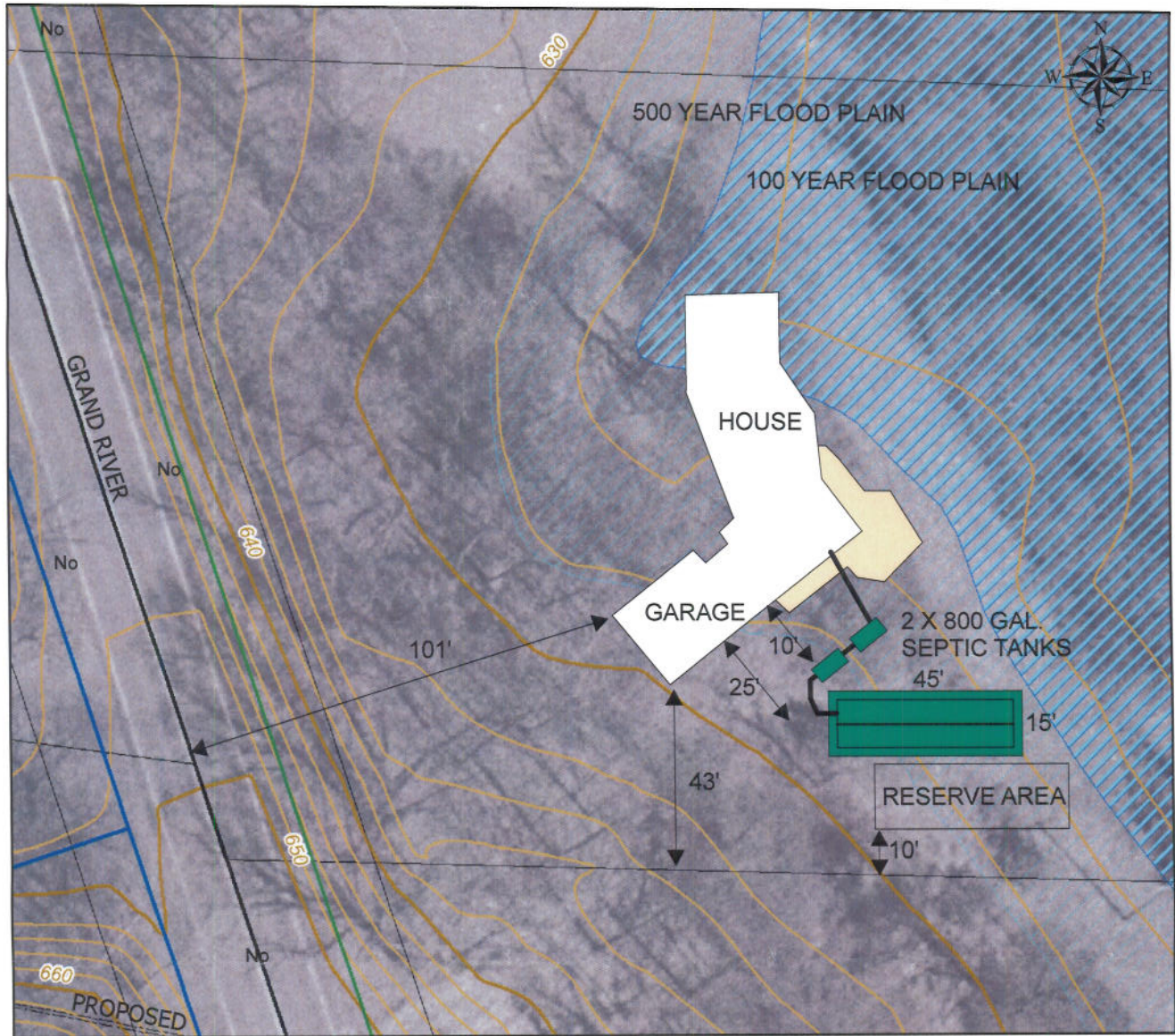

**Legend**

- PROPERTY LINES
- ~ 2' CONTOURS
- PROPOSED SEPTIC COMPONENTS
- ▨ Fema Flood Areas 2005 Draft

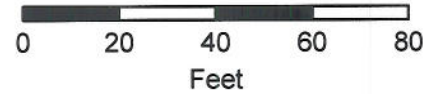

Signature of Sanitarian: *James Bork*

Date Issued: 6/6/06